

# AC Solid State Relay

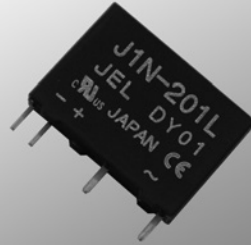

# J1

SERIES



Solid State Relay  
J1 series

## Features

- Miniature size, Slim appearance
- Max. load current at 1.5A
- Available for PCB high-density packaging
- Dielectric strength between input and output at 3,000V/1 min.
- UL/C-UL standard approved

## Type Information

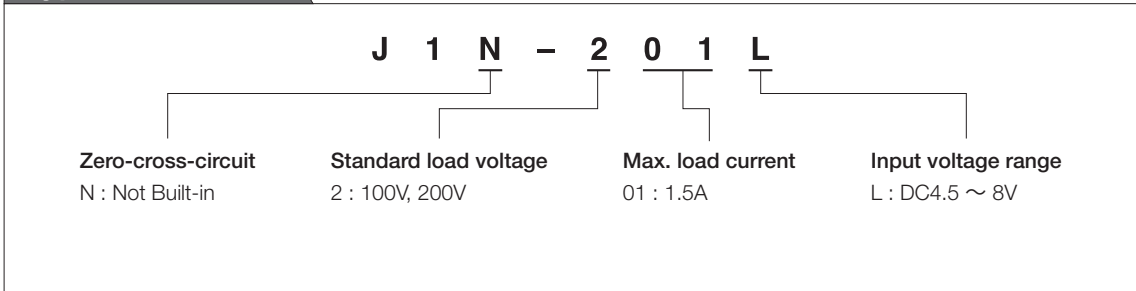

## Characteristics

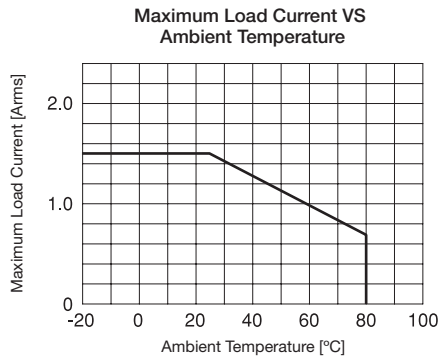

※ Description in the catalogue is subject to change without notice. Please read the specifications thoroughly before using.  
 ※ Please contact JEL SYSTEM for further information.

## Dimensions (mm)

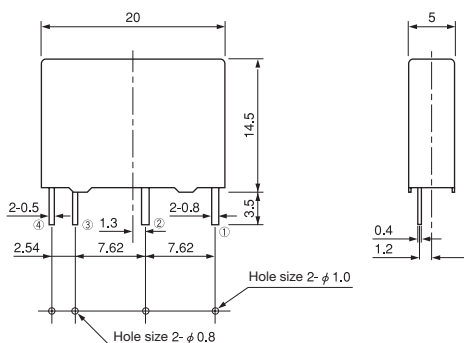

Dimensions For PCB Design

## Equivalent Circuit

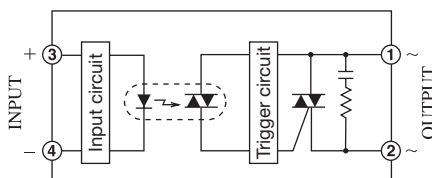

※ Description in the catalogue is subject to change without notice. Please read the specifications thoroughly before using.  
 ※ Please contact JEL SYSTEM for further information.

## ■ Ratings

(Ta = 25 °C)

	Item	Symbols	J1N-201L	Units
Output	Rated Load Voltage	—	120, 240	V <sub>ACrms</sub>
	Maximum Load Current	I <sub>OMAX</sub>	1.5	A <sub>ACrms</sub>
	Maximum Load Voltage	V <sub>OMAX</sub>	264	V <sub>ACrms</sub>
	Peak Repetitive Off State Voltage	V <sub>DRM</sub>	600	V
	Peak 1 Cycle Surge Current	I <sub>SURGE</sub>	50 (60Hz)	A
	Frequency	f	50, 60	Hz
Input	Maximum Input Voltage	V <sub>IMAX</sub>	8	V <sub>DC</sub>
	Input Impedance	R <sub>IN</sub>	390 ± 20%	Ω
General	Dielectric Strength	V <sub>ISO</sub>	3,000/1 min. (Between input and output)	V <sub>ACrms</sub>
	Isolation Resistance	R <sub>ISO</sub>	10 <sup>9</sup> and above DC500V (Between input and output)	Ω
	Operating Temperature Range	T <sub>OPR</sub>	- 20 ~ + 80	°C
	Storage Temperature Range	T <sub>STG</sub>	- 30 ~ + 100	°C

## ■ Electrical Characteristics

	Item	Symbols	J1N-201L	Units
Output	Load Voltage Range	V <sub>O</sub>	50 ~ 264	V <sub>ACrms</sub>
	Off State Leakage Current	I <sub>LEK</sub>	1.0 and below (V <sub>O</sub> = 200V)	mA <sub>ACrms</sub>
	On State Voltage Drop	V <sub>SAT</sub>	1.5 and below	V <sub>ACrms</sub>
	Minimum Load Current	I <sub>OMIN</sub>	10	mA
Input	Input Voltage Range	V <sub>I</sub>	4.5 ~ 8	V <sub>DC</sub>
	Operate Voltage	V <sub>P</sub>	4.5 and below	V <sub>DC</sub>
	Release Voltage	V <sub>D</sub>	1 and above	V <sub>DC</sub>
General	Operate Time	T <sub>ON</sub>	1ms and below	/
	Release Time	T <sub>OFF</sub>	1/2 Cycle + 1ms and below	/
	Capacitance	C <sub>IO</sub>	15 and below	PF
	Zero Cross Turn On		Not Built In	/
	Approved Standards		UL、C-UL	/

※ Description in the catalogue is subject to change without notice. Please read the specifications thoroughly before using.

※ Please contact JEL SYSTEM for further information.

Peak Surge Current VS Duration

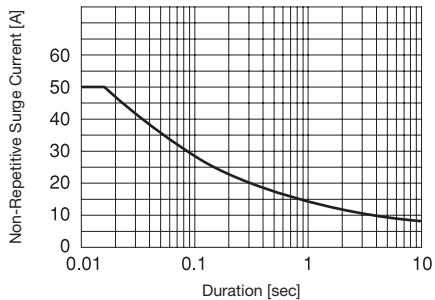

Input Current VS Input Voltage (Typical value)

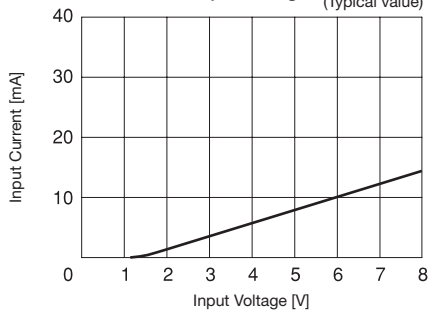

Input Characteristics VS Ambient Temperature (Typical value)

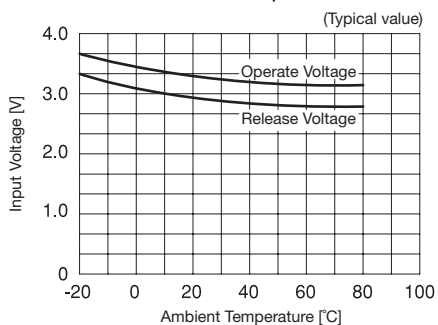

※ Description in the catalogue is subject to change without notice. Please read the specifications thoroughly before using.  
 ※ Please contact JEL SYSTEM for further information.